

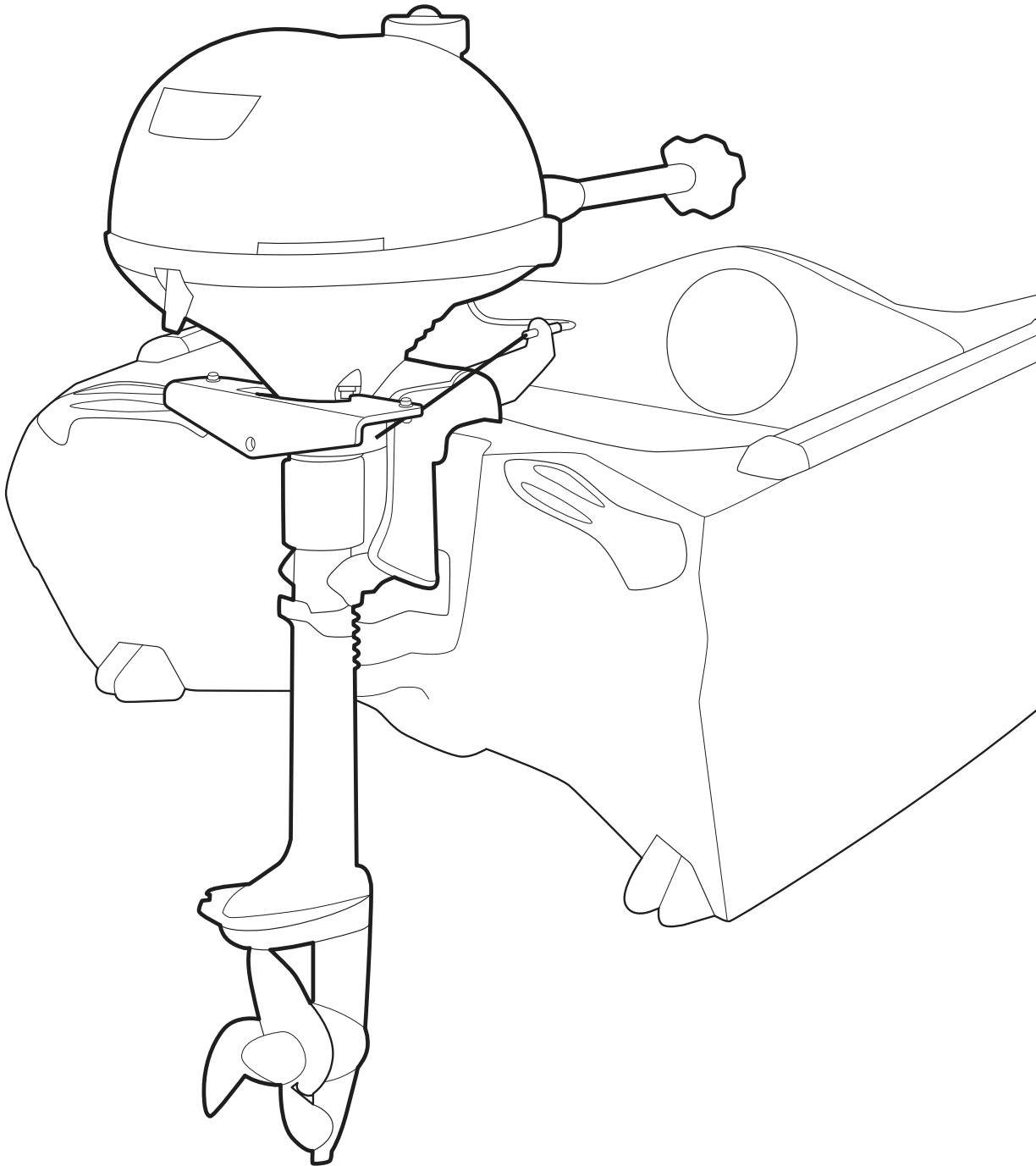

GO YOUR OWN WAY



Jonny Honda 2.3 HP Motor Kit Instruction Manual

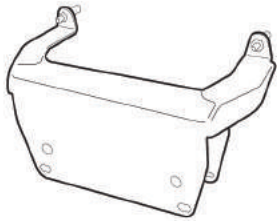
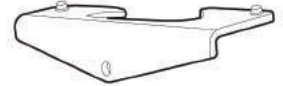
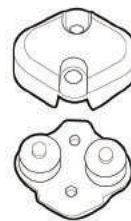
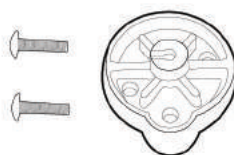
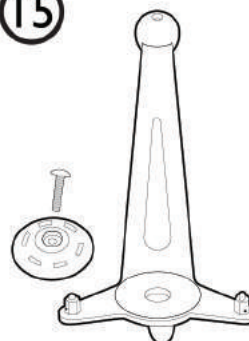

Jonny Honda 2.3 HP Motor Kit Part Lists

①**②****③****④****⑤****⑥****⑦****⑧****⑨****⑩****⑪****⑫****⑬****⑭****⑮**



Jonny Honda 2.3 HP Motor Kit Part Lists

No.	Part number	Description	Qty.
1	64074	Outboard transom plate	1 set
2	64053	Screw TH M6x20	2 Pcs.
3	64066	Screw JT M6x10	2 Pcs.
4	64077	Jonny honda 2.3 HP T-Bar	1 Pcs.
5	50150	Socket cap screw M6x35	2 Pcs.
6	NA	Outboard extension set	1 Set
7	64071	Screw TH M5x15	2 Pcs.
8	NA	Cable tube set	1 Set
9	62080	Wire cable	2 Pcs.
10	64006	Screw JF M4x25	2 Pcs.
11	NA	Top cap para set	1 Set
12	47240	Cable stop	1 Pcs.
13	64038	Screw FH M4x20 (Black)	2 Pcs.
14	NA	Outboard steering pivot point set	1 Set
15	NA	Motor tiller set	1 Set

Jonny Honda 2.3 HP Motor Kit Instruction Manual

- 1** Install the transom plate with the boat.

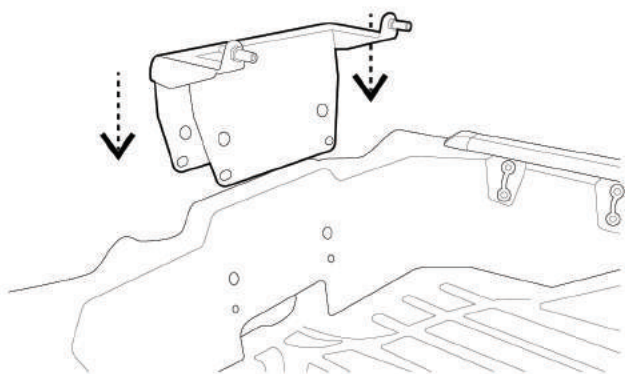

- 2** Tighten the JT M6x10 screw with the plate.

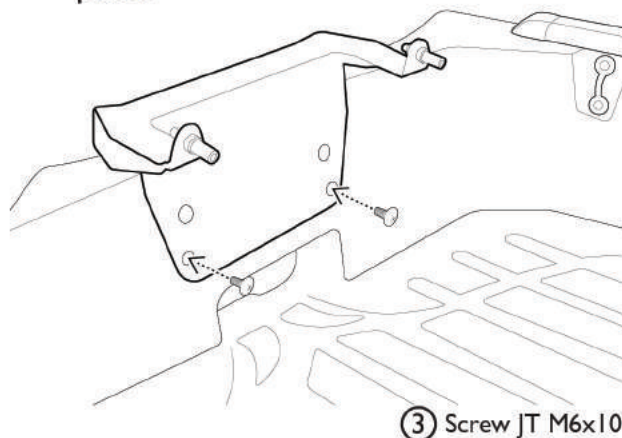

- 3** Tighten the TH M6x20 screw with the plate.

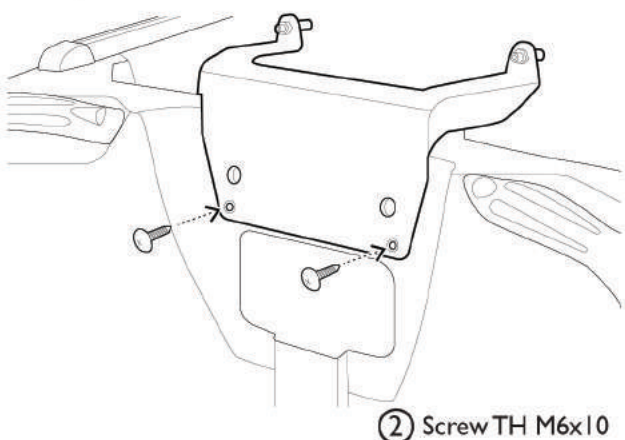

- 4** Install the Outboard with the transom plate.

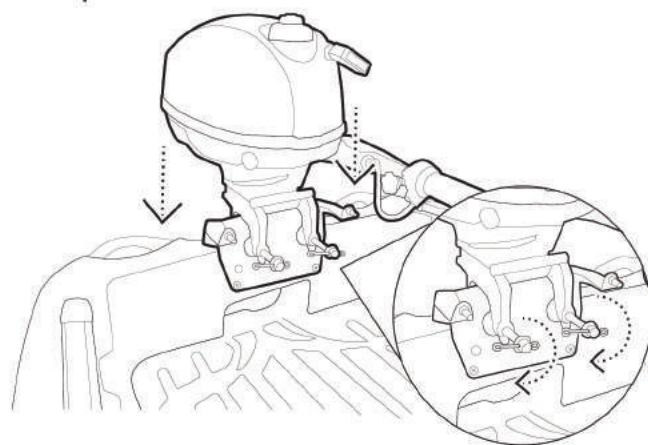

- 5** Remove 2 bolts from the outboard.

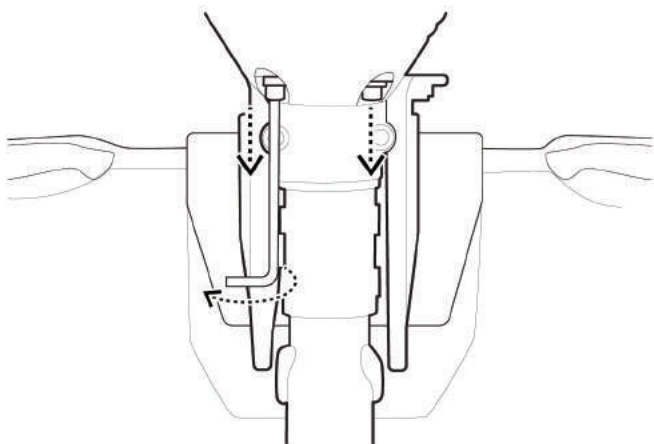

- 6** Install the Honda 2.3 HP T-bar with the outboard replace with socket cap screw M6x35.

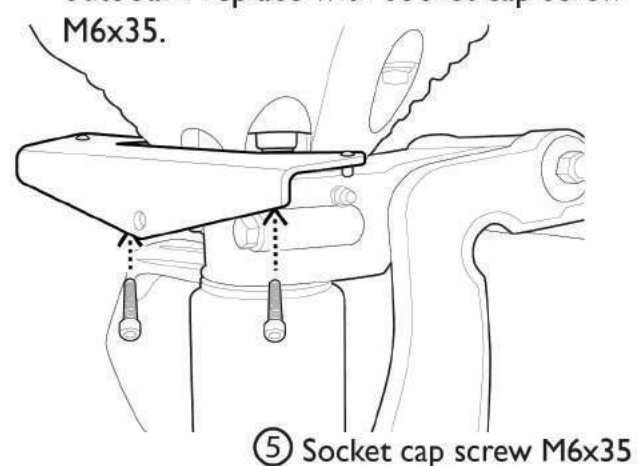

Jonny Honda 2.3 HP Motor Kit Instruction Manual

- 7** Install the cable tube into the tube holders on the transom plate.

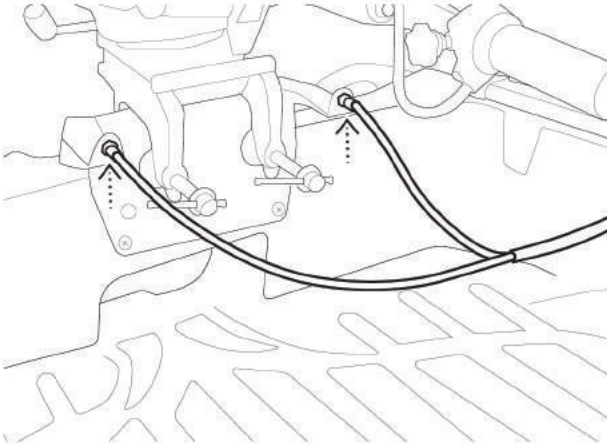

- 8** Install the cable stop and the cable tube, into the boat.

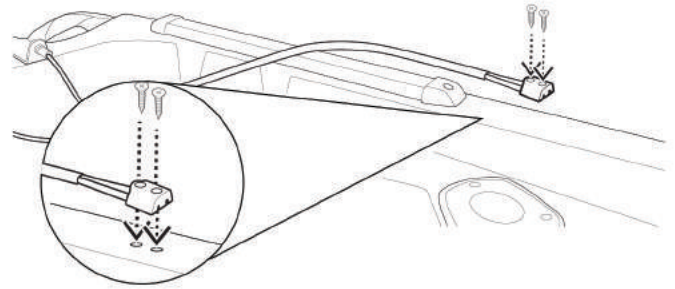

(13) Screw FH M4x20

- 9** Install the top cap para set.

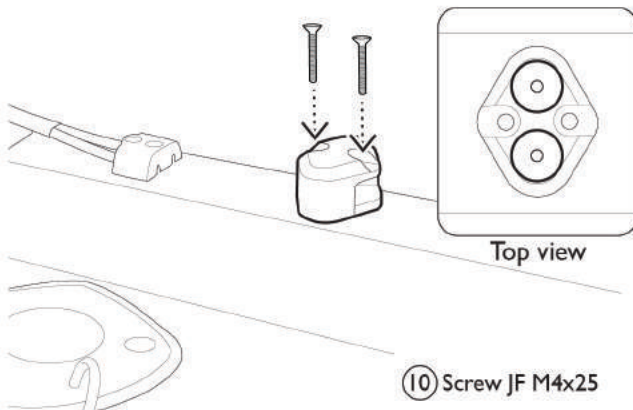

(10) Screw JF M4x25

- 10** Install the motor tiller pivot point.

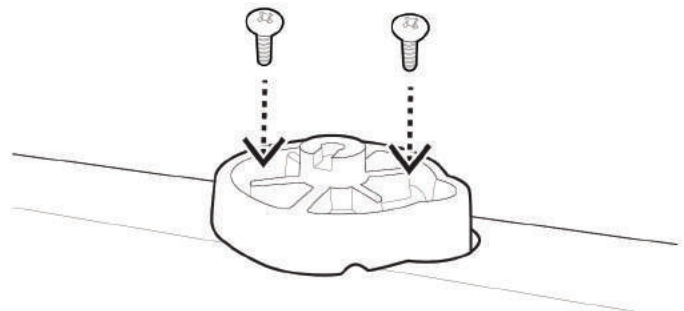

Screw JT M6x20

- 11** Install the motor tiller set.

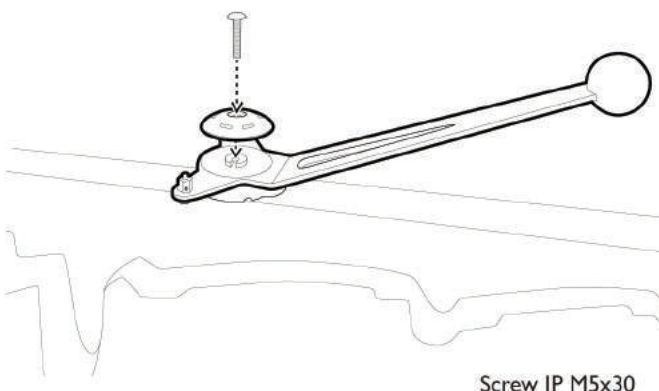

Screw JP M5x30

- 12** Insert the wire cable into the cable tube.

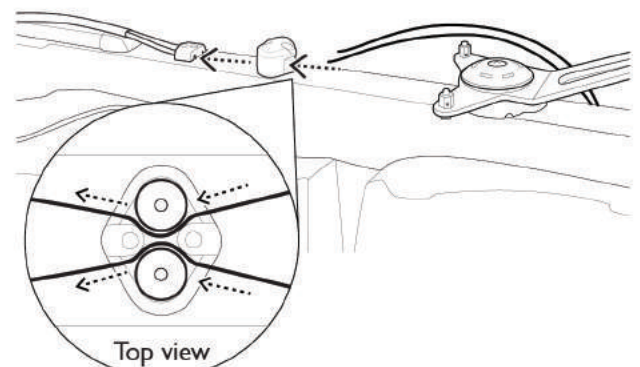

Jonny Honda 2.3 HP Motor Kit Instruction Manual

- 13** Insert the wire cable through the cable lock nut and tighten the grub screw.

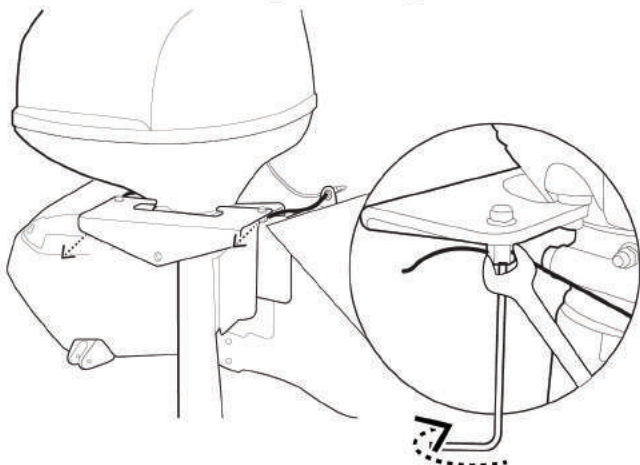

- 14** Insert the wire cable through the cable lock nut at the motor tiller set.

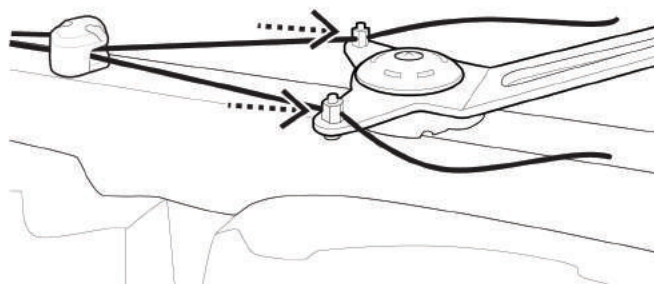

- 15** Set the degree of motor tiller set.

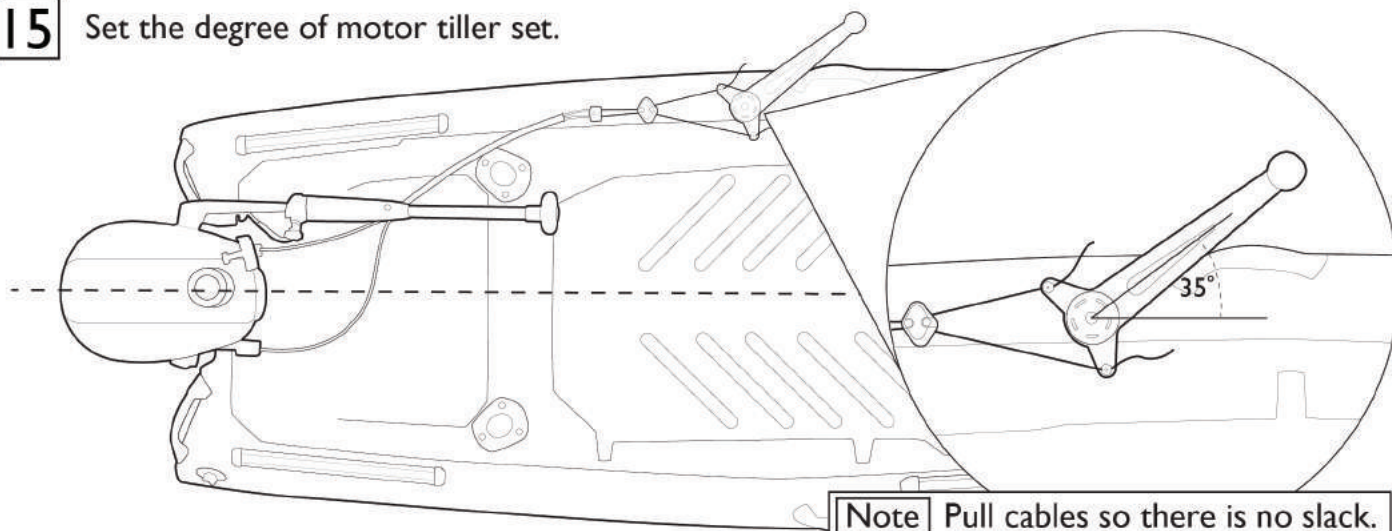

- 16** Tighten the grub screw at the motor tiller set.

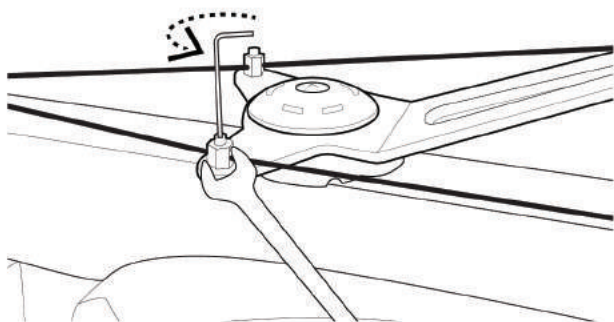

- 17** Cut the wire cable and install the cable end cap.

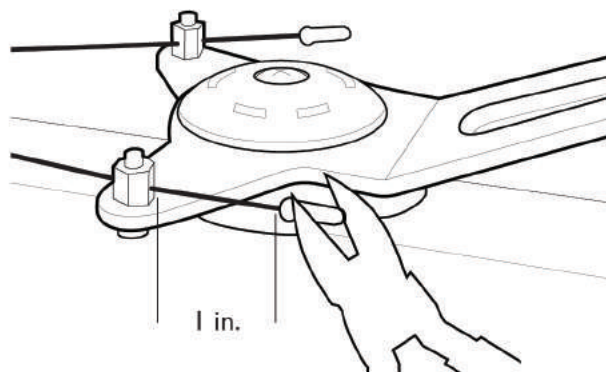

Jonny Honda 2.3 HP Motor Kit Instruction Manual

- 22** Install the extension set with the handle.

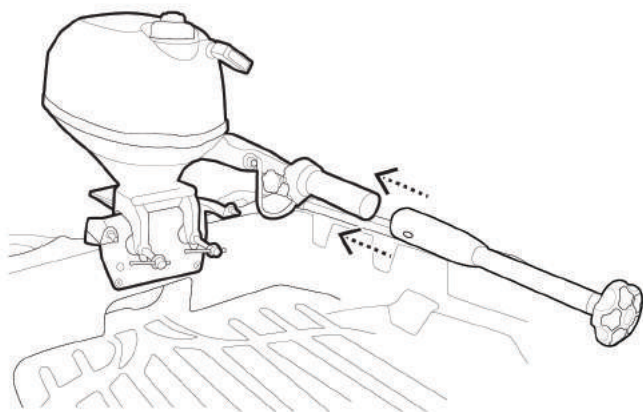

- 23** Tighten with the screws TH M5x15 to just nip rubber tiller grip.

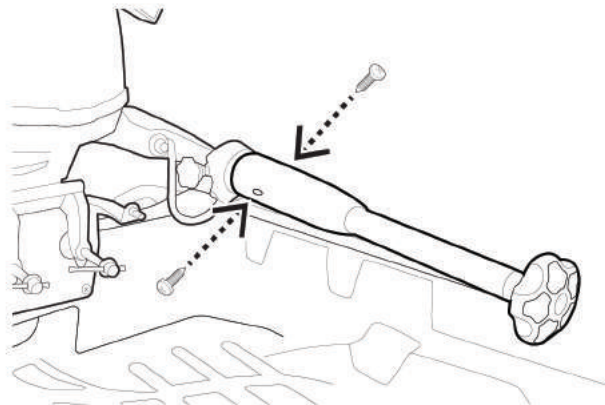

⑦ screw TH M5x15

- 24**

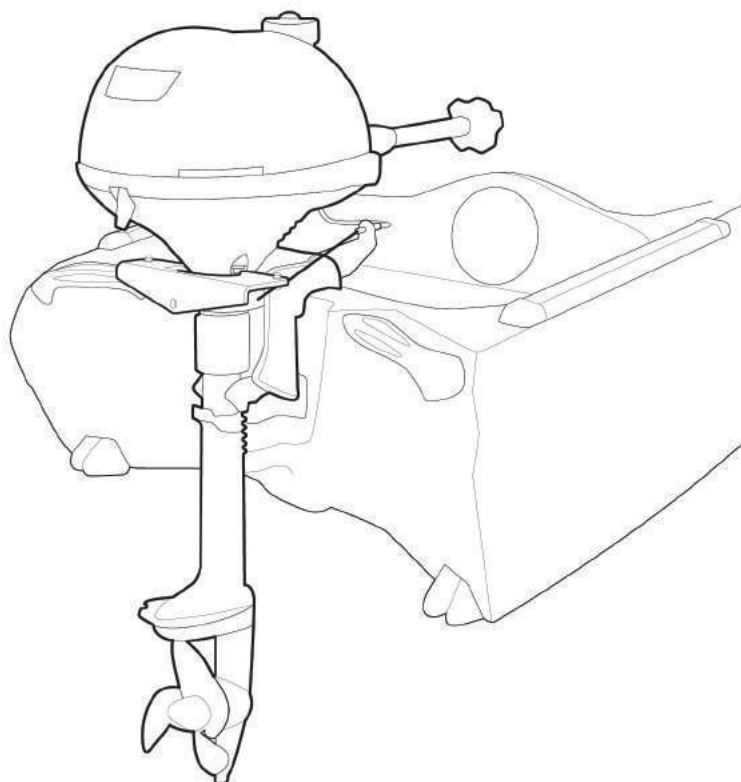



HONDA OUTBOARD MOTOR KIT

Congratulations on the purchase of your Jonny Boats Bass 100 and the Honda Outboard Motor Kit. For detailed installation instructions, scan the QR code below or visit www.vimeo.com/341420682



JONNYBOATS.COM